

1	2	3	4	5	6	7	8	9	10	11	12	13	14	15	16	17	18	19	20	21								
106,800																												
51,000												8,000					45,300				2,500							
9,100				19,000				8,500				14,400				32,300				13,000								
1,850	7,150	4,600	4,800	4,800	4,800	4,800	4,500	4,000	4,800	4,800	4,800										4,800	5,750	5,750	5,750	5,750	4,500	6,500	6,500

13,350	20,325	6,850	6,850	6,850	6,850	6,850	6,850	6,850	6,850	6,850	6,850	6,850	6,850	6,850	6,850	6,850	6,850	6,850	6,850	6,850	6,850	6,850	6,850	6,850	6,850	6,850
47,175	47,175	47,175	47,175	47,175	47,175	47,175	47,175	47,175	47,175	47,175	47,175	47,175	47,175	47,175	47,175	47,175	47,175	47,175	47,175	47,175	47,175	47,175	47,175	47,175	47,175	47,175

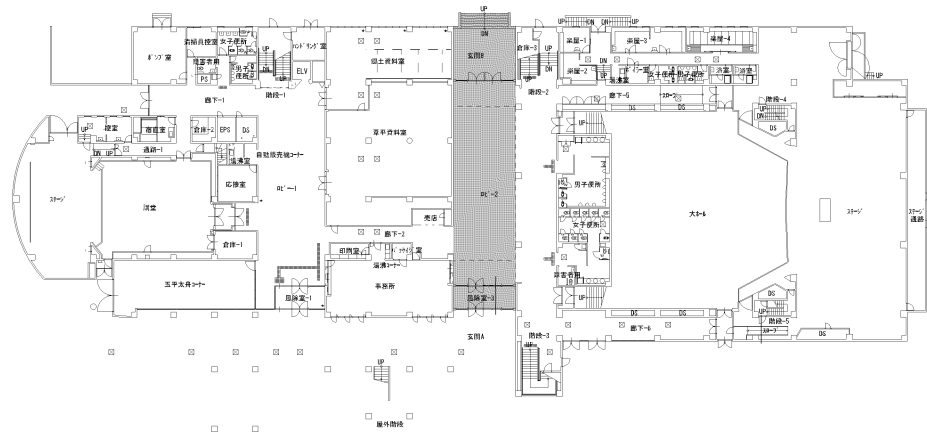

13,350	20,325	6,850	6,850	6,850	6,850	6,850	6,850	6,850	6,850	6,850	6,850	6,850	6,850	6,850	6,850	6,850	6,850	6,850	6,850	6,850	6,850	6,850	6,850	6,850	6,850	6,850
47,175	47,175	47,175	47,175	47,175	47,175	47,175	47,175	47,175	47,175	47,175	47,175	47,175	47,175	47,175	47,175	47,175	47,175	47,175	47,175	47,175	47,175	47,175	47,175	47,175	47,175	47,175

1階平面図 S=1:300

1	2	3	4	5	6	7	8	9	10	11	12	13	14	15	16	17	18	19	20	21			
51,000												8,000				45,300					2,500		
9,100				19,000				8,500				14,400				32,300				13,000			
850	7,150	4,600	4,800	4,800	4,800	4,800	4,500	4,000	4,800	4,800	4,800	4,800	4,800	4,800	4,800	4,800	4,800	4,800	4,800	4,800			

13,350	20,325	6,850	6,850	6,850	6,850	6,850	6,850	6,850	6,850	6,850	6,850	6,850	6,850	6,850	6,850	6,850	6,850	6,850	6,850	6,850	6,850	6,850	6,850	6,850	6,850	6,850
47,175	47,175	47,175	47,175	47,175	47,175	47,175	47,175	47,175	47,175	47,175	47,175	47,175	47,175	47,175	47,175	47,175	47,175	47,175	47,175	47,175	47,175	47,175	47,175	47,175	47,175	47,175

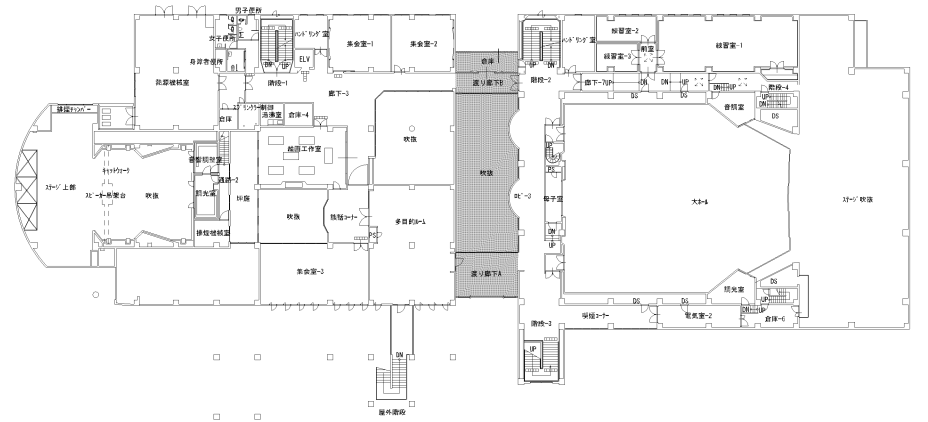

13,350	20,325	6,850	6,850	6,850	6,850	6,850	6,850	6,850	6,850	6,850	6,850	6,850	6,850	6,850	6,850	6,850	6,850	6,850	6,850	6,850	6,850	6,850	6,850	6,850	6,850	6,850
47,175	47,175	47,175	47,175	47,175	47,175	47,175	47,175	47,175	47,175	47,175	47,175	47,175	47,175	47,175	47,175	47,175	47,175	47,175	47,175	47,175	47,175	47,175	47,175	47,175	47,175	47,175

2階平面図 S=1:300

特記事項	北九州市建築都市局建築部建築課	図面名	1～2階平面図	工事名	若松市民会館（中央エリア）改修工事	工費概算	429（17）	作成年月	平成29年03月
	設計事務所 株式会社河野建築設計事務所					縮尺	1:300	図面番号	A008/091

①	②	③	④	⑤	⑥	⑦	⑧	⑨	⑩	⑪	⑫	⑬	⑭	⑮	⑯	⑰	⑱	⑲	⑳	㉑		
51,000											8,000										2,500	
9,100											32,300										13,000	
8,950	7,150	4,600	4,800	4,800	4,800	4,500	4,000	4,800	4,800	4,800	4,800	4,800	5,750	5,750	5,750	5,750	4,500	6,500	6,500			

㉓	㉔	㉕	㉖	㉗	㉘	㉙	㉚	㉛	㉜	㉝	㉞	㉟	㊱	㊲	㊳	㊴	㊵	㊶	㊷	㊸	㊹
13,350	20,325	6,850	6,850	6,025	6,500	7,000	12,500	6,500	5,500	1,500	5,500	6,500	47,175	20,325	6,850	6,850	6,025	6,500	7,000	12,500	6,500

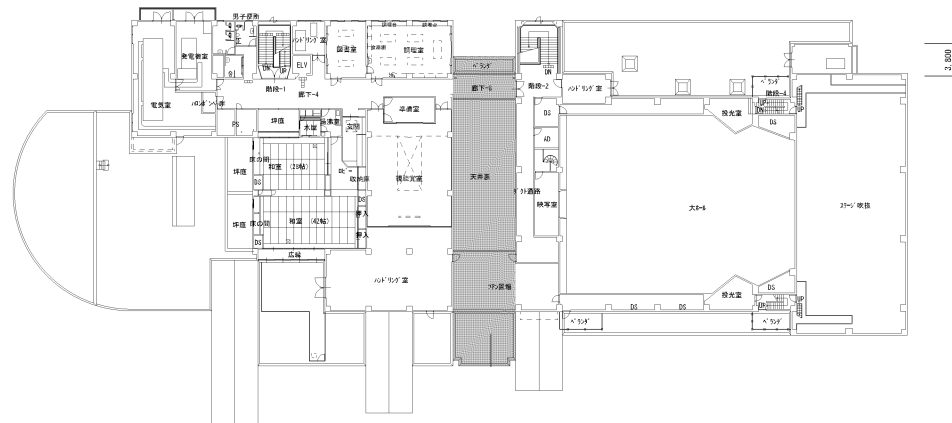

㉓	㉔	㉕	㉖	㉗	㉘	㉙	㉚	㉛	㉜	㉝	㉞	㉟	㊱	㊲	㊳	㊴	㊵	㊶	㊷	㊸	㊹
6,500	2,875	8,100	8,100	26,550	42,050	8,100	8,100	8,100	8,100	8,100	8,100	8,100	8,100	8,100	8,100	8,100	8,100	8,100	8,100	8,100	8,100

3階平面図 S=1:300

①	②	③	④	⑤	⑥	⑦	⑧	⑨	⑩	⑪	⑫	⑬	⑭	⑮	⑯	⑰	⑱	⑲	⑳	㉑									
51,000												8,000				45,300					2,500								
9,100												19,000										8,500				14,400			
850		7,150		4,800		4,800		4,800		4,800		4,500		4,000		4,800		4,800		4,800									

㉓	㉔	㉕	㉖	㉗	㉘	㉙	㉚	㉛	㉜	㉝	㉞	㉟	㊱	㊲	㊳	㊴	㊵	㊶	㊷	㊸	㊹
13,350	20,325	6,850	6,850	6,025	6,500	7,000	12,500	6,500	5,500	1,500	5,500	6,500	47,175	20,325	6,850	6,850	6,025	6,500	7,000	12,500	6,500

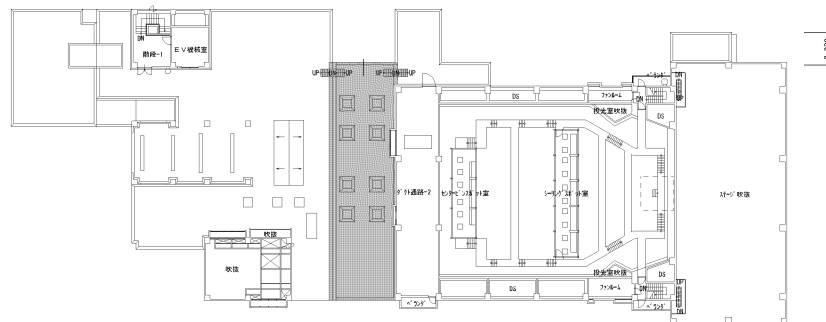

㉓	㉔	㉕	㉖	㉗	㉘	㉙	㉚	㉛	㉜	㉝	㉞	㉟	㊱	㊲	㊳	㊴	㊵	㊶	㊷	㊸	㊹
6,500	2,875	8,100	8,100	26,550	42,050	8,100	8,100	8,100	8,100	8,100	8,100	8,100	8,100	8,100	8,100	8,100	8,100	8,100	8,100	8,100	8,100

4階平面図 S=1:300

特記事項				北九州市建築都市局建築部建築課				工事名 若松市民会館（中央エリア）改修工事				1:300		A009/091	
設計事務所 株式会社河野建築設計事務所				図面名 3～4階平面図				1:300				A009/091			